

5" & 6" LED RETROFIT LUMINAIRE WITH INTEGRATED TRIM

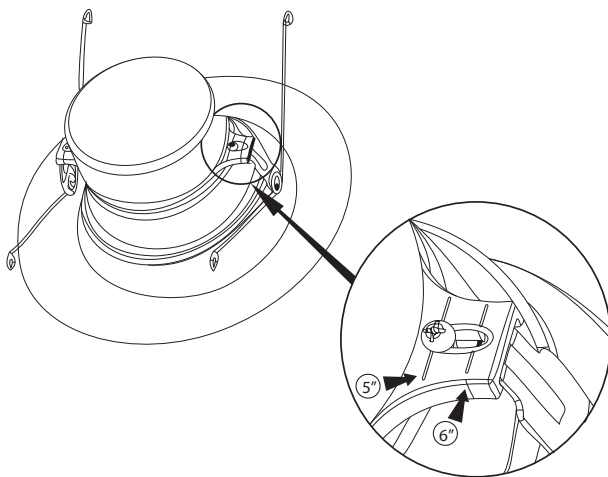

fig.1a

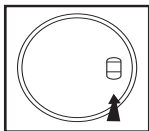

fig.1b

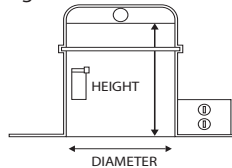

fig.2a

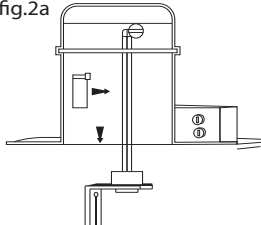

fig.2b

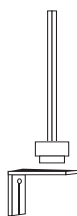

fig.3

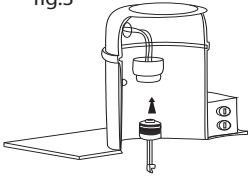

fig.4

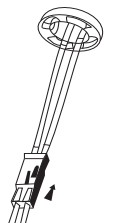

fig.5

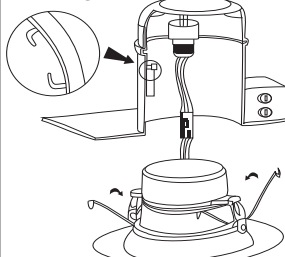
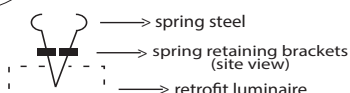
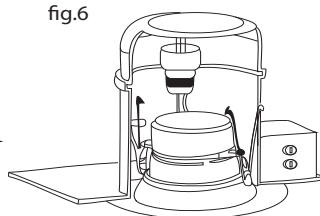

fig.6



HOUSINGS:

This recessed luminaire has an E26 Edison screw-in connector and is UL listed for installation in shallow recessed housings.

HALO:

H71CT, H71CAT I CATNB, H7RICAT, H7RICT, H7UICAT, H7UICT, h750RICAT, H750IC, H27ICT, H27RICAT, H5RICAT, H750TCP.

ALO-PRO:

EI 700, EI700ATNB, EI1700NB, EI700RAT, EI700U, EI700UAT, Ei2700, EI2700AT, EI500AT, EI500RAT.

Juno: ICC22, IC22R, IC22W, IC22WS, IC23, IC23W, IC21, IC21R, IC25, IC25W, IC25S.

Capri: CRI, PR1, QLT, R9ASIC.

Li-honoo: L7X, L7XP.

Thomas: PS1

Commercial Electric: H3(C7ICA)

Elco: EL7ICA(EL7ICA)

QUICK INSTALLATION GUIDE

Step 1. Make sure the POWER IS TURNED OFF at the source to the recessed housings inside which you are installing the products. Once power has been turned off, remove the existing trim and bulb.

Step 2. Unscrew the lamp socket mounting bracket inside the recessed housing (fig.2a). Unclip the lamp socket from the bracket and discard the bracket (fig. 2b).

Step 3. Screw supplied Edison base adaptor into the socket (fig.3).

Step 4. Plug the female connector of the retrofit kit into the male connector of the socket adaptor (fig.4).

Step 5. Squeeze the spring wires of the retrofit kit together and insert them inside the housing retaining bracket (fig. 5). Carefully tuck all wires inside and gently push the retrofit kit up into recessed housing. (fig.6).

HOUSING COMPATIBILITY

Compatible with most standard 5" and 6" insulated and non-insulated housings that have spring retaining brackets inside (fig.5). Compatibility of housing may be determined by measurement of the housing as detailed in (fig.1b). The mounting width is adjustable from 5" to 6" by moving the spring wire brackets held by the nearby retaining screws.

5" & 6" LED RETROFIT LUMINAIRE WITH INTEGRATED TRIM

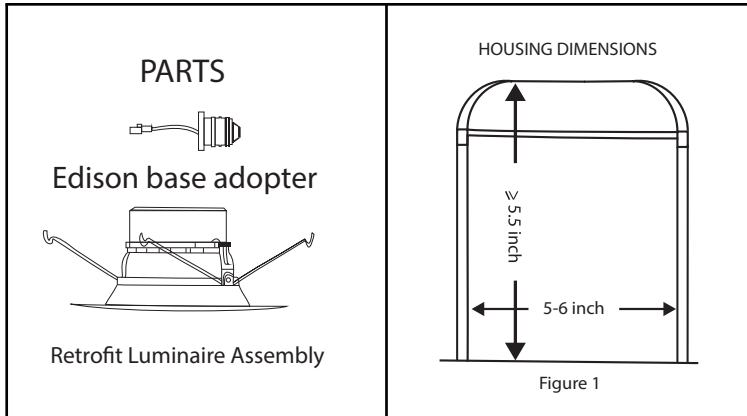

INSTALLATION INTO RECESSED HOUSING AND DIMMER COMPATIBILITY

- LED Retrofit Luminaire is designed to install in standard 5" or 6" diameter recessed down light housing.
- Lutron or Leviton dimmer recommended.
- Compatibility of housing not on this list may be determined by measurement of the housing as detailed in the attached drawing (Figure 1).

NOTE:

1. Before starting installation, please read complete leaflet and keep for future reference.
2. To avoid possible electrical shock, be sure that power is turned off at fuse box or circuit breaker before installing or servicing fixture.
3. During installation do not let the product surface rub against other hard objects or drop on the floor, otherwise the product may be damaged.
4. Conductors (power wires) connecting the fixture must be rated minimum 90 C to reduce risk of fire. If uncertain, consult an electrician.
5. The luminaire must be securely mounted and any bare wires of the power cord must be properly insulated to prevent electrical hazards.
6. For indoor use only, suitable for damp locations. Do not expose retrofit kit to water and other liquids in order to avoid electric shock.
7. Installation of any recessed lighting luminaire must meet local electrical code. This code sets the wiring standards for your locality and should be carefully studied before starting.
8. Protect the light from dust and dirt when painting or during construction.
9. Clean with a soft damp cloth only, do not use any chemical cleaners.

not expose wiring to edge of sheet metal or other sharp object.

- WARNING - Do not make or alter any open holes in wiring enclosure or electrical components during kit installation.
- WARNING-RISK OF FIRE OF ELECTRIC SHOCK. DO NOT ALTER, RELOCATE OR REMOVE WIRING, LAMPHOLDERS, POWER SUPPLY, OR ANY OTHER ELECTRICAL COMPONENTS.
- WARNING-RISK OF FIRE OF ELECTRICAL SHOCK. INSTALLATION OF THIS RETROFIT ASSEMBLY REQUIRES A PERSON FAMILIAR WITH THE CONSTRUCTION AND OPERATION OF THE LUMINAIRE'S ELECTRICAL SYSTEM AND THE HAZARD INVOLVED. IF NOT QUALIFIED, DO NOT ATTEMPT INSTALLATION. CONTACT A QUALIFIED ELECTRICIAN.
- CAUTION: SHOCK AND FIRE HAZARD. DO NOT USE WHEN ENCLOSURE IS BROKEN.
- SUITABLE FOR USE IN ENCLOSED RECESSED LUMINAIRES.
- MIN. LAMP COMPARTMENT DIMENSIONS: 5 (D) X 4.5(H) INCHES where D is minimum diameter and H is minimum height of Listed Recessed luminaire Compartment, as applicable.
- SUITABLE FOR INSTALLATION IN DAMP LOCATIONS.
- SUITABLE FOR BOTH UL TYPE IC and NON-IC HOUSINGS.

IMPORTANT SAFETY INSTRUCTIONS

- WARNING- Risk of fire or electric shock. LED Retrofit Kit installation requires knowledge of electrical system. If not qualified, do not attempt installation. Contact a qualified electrician.
- WARNING – Risk of electrical shock. Install these kits only in the housings with feature and dimensions shown in the drawings.
- WARNING- To prevent wiring damage or abrasion, do

WARRANTY:

We offer a 5 year limited warranty. As with any electrical installation, a qualified electrician must ensure compatibility of use with a particular housing; this includes all applicable national and local electrical and building codes. Installer is responsible to securely retain the LED Module in a housing at time of installation.